



Unistrut International
 16100 S. Lathrop Ave.
 Harvey, IL 60426

DESIGN LOAD REPORT

Phone: 708-339-1610
 800-882-5543
 Fax: 708-339-7814

www.unistrut.com

Part Description: P2942
 Report Date: September 9, 2005

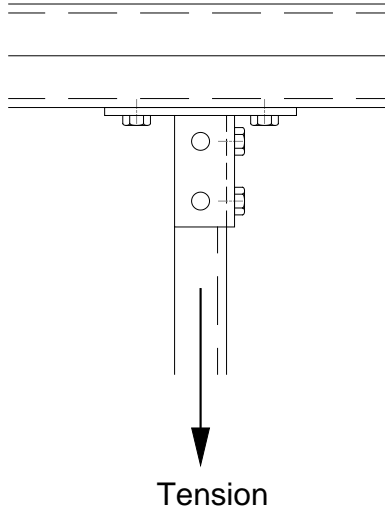

Ave. Ultimate Tension (lbs)	Design Tension Load (lbs)	Ave. Deflection at Design Tension Load
11,800	3,000	0.126"

NOTES

1. Ave. Ultimate Load from Test T-064
2. Testing Based on 1/2"-13 Channel Nuts & Cap Screws Torqued to 50 ft-lbs
3. Averaged Safety Factor = 3.9
4. Design Load Limited to 3,000 lb Slip Load of Two (2) 1/2"-13 Channel Nuts, SF = 3
5. Deflection is the Average Deflection Reading at 3,000 lbs
6. Deflection is Measured in the Direction of the Tension Load

Unistrut Engineering



Columbia-MBF



KAF-TECH



UNISTRUT



UNISTRUT Construction

