

# Unipier Rooftop Pipe Support System

**UNISTRUT**<sup>®</sup>

A PART OF **Atkore**  
INTERNATIONAL

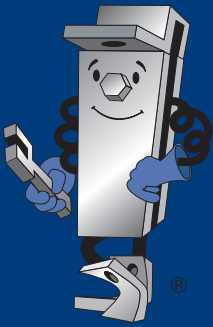

Unistrut has evolved from a simple connection concept to a comprehensive engineered building and support system featuring a robust line of channels, fittings, fasteners, hangers, pipe clamps, accessories and Unipier Rooftop Pipe Support Systems. The new Unipier Rooftop Support System offers a full line of supports for conduit, gas, and mechanical piping, HVAC Ducts, equipment supports, walkways and more.

## ROLLER SUPPORTS

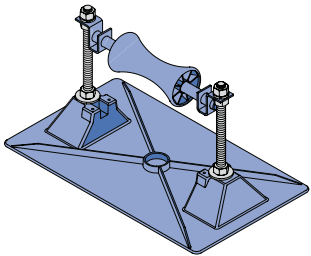

### DESCRIPTION

- A "roller-bearing" pipe support used to support roof-mounted gas pipes, electrical conduit, solar piping and other mechanical piping. Unique design absorbs thermal expansion and contraction of pipes thus preventing damage to the roof membrane.

### AVAILABLE IN THE FOLLOWING CONFIGURATIONS

- Accommodates pipes from 1.5" to 10" diameter
- Height off roof deck ranges from 2" to 18"
- Weight limits range from 48 lbs. to 640 lbs.
- Max spacing 10 feet O.C. depending upon the load

### SPECS

- 20 year warranty
- Under 2.0 PSI

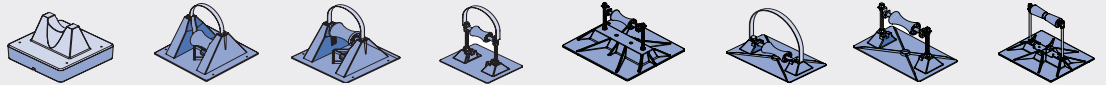

\* We can design and build the proper support based upon width and length desired

## CONDUIT SUPPORTS

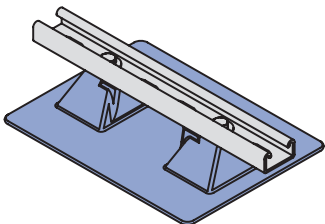

### DESCRIPTION

- A pipe support with "strut" used to support roof-mounted electrical conduit, solar piping, and other mechanical piping. Pipes rest on a strut system, which is made of hot-dip galvanized steel, pipes can be fastened by using typical clamps locked to the strut. The base is gently rounded to allow movement upon the roof to prevent gouging of the roof membrane.

### AVAILABLE IN THE FOLLOWING CONFIGURATIONS

- Strut lengths from 12" to 24" (Custom sizes available)
- Height off roof deck ranges from 2.5" to 18"
- Weight limits from 115 lbs. to 640 lbs.
- Max spacing 10 feet O.C. depending upon the load

### SPECS

- 20 year warranty
- Under 2.0 PSI



\* Not all configurations shown here

## MECHANICAL SUPPORTS LD

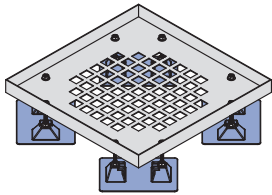

### DESCRIPTION

- Mechanical Unit Supports are designed to elevate rooftop mechanical units such as air conditioning or other devices. These supports are engineered so the mechanical units rest in heavy-duty corner or side supports. The supports are anchored to bases designed to protect the roof membrane. The Mechanical Unit Supports are fully adjustable in height. All metal components are made of hot-dip galvanized steel for superior weatherability.

### CONFIGURATIONS

- Light Duty Mechanical Supports Available in the following sizes 18"x18", 24"x24", 30"x30", 36"x36"
- Heavy Duty Mechanical Supports Available in Custom sizes
- Weight distribution engineered to 2 PSI
- Spacing as per HVAC manufacturer requirements

### SPECS

- 20 year warranty
- Under 2.0 PSI

## DUCT AND CABLE TRAY SUPPORTS

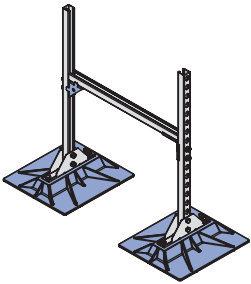

### DESCRIPTION

- An "H" frame is constructed of strut and patented bases are used to support duct on flat roofs. Unique design allows a sturdy support without penetrating or causing damage to the roof membrane. Ducts rest on a strut and are designed for job project specifications.

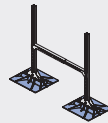

\* Not all configurations shown here

### CONFIGURATIONS

- All other configurations are custom to meet your needs
- Weight distribution engineered to 2 PSI
- Spacing as determined based on engineering

### SPECS

- 20 year warranty
- Under 2.0 PSI

## WATER AND STEAM SUPPORTS

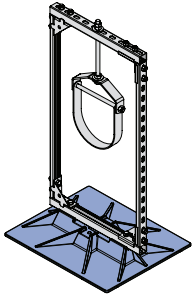

### DESCRIPTION

- A "roller-bearing", "clevis hanger", or "band hanger" pipe support, used to support roof-mounted gas pipes, HVAC piping, electrical conduit, solar piping and other mechanical piping. Unique design absorbs thermal expansion and contraction of pipes thus preventing damage to the roof membrane. Pipes rest on a polycarbonate or steel roller, clevis hanger or band hanger.

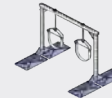
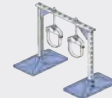

\* Not all configurations shown here

### CONFIGURATIONS

- All units custom fabricated to order based on pipe size, materials carried and height
- All other configurations are custom to meet your needs
- Weight distribution engineered to 2 PSI
- Spacing as determined based on engineering

### SPECS

- 20 year warranty
- Under 2.0 PSI

## BRIDGE CROSSOVERS, WALKWAY, & RAMP SYSTEMS

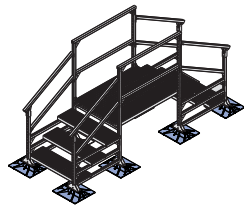

### DESCRIPTION

- The Unipier Bridge Crossover, Walkway, Service Platform, & Platform Systems are designed to provide access over piping, duct, equipment, or high or lower areas of a roof surface.

### SPECIFICATIONS

- All units custom fabricated to order based on height and elevation differentials
- All configurations are custom to meet your needs height, width and length
- Weight distribution engineered to 2 PSI

### SPECS

- 20 year warranty
- Under 2.0 PSI

## SEISMIC AND WIND UPLIFT

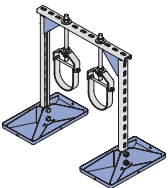

### DESCRIPTION

- Seismic and wind up-lift series supports are designed to project specific requirements.

### SPECIFICATIONS

- The Seismic & Wind Up-Lift Supports and its related configurations allow adjustable height as desired or required by the code or roof system

- Each model configured to allow vertical and some lateral adjustment as specified
- Purchasers should specify code design criteria, desired heights and spacing when inquiring about each project application.
- Seismic and Wind Up-Lift supports engineered to ensure member/component capacities and deflection criteria are not exceeded

- Engineering and Stamps available

### SPECS

- 20 year warranty
- Under 2.0 PSI

## ROOFTOP SLEEPER SUPPORT

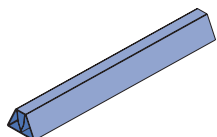

### DESCRIPTION

- The Unipier rooftop sleeper is the first rooftop support that is white to reflect the sun's UV rays. It is cost-effective, lightweight and can be cut to the desired length while on the job site. The model RSS4 is conveniently packaged in shrink wrap bundles of 9-4 ft. supports that can be easily carried to the rooftop.

### SPECIFICATIONS

- The Unipier sleeper support is lightweight, just 4 lbs./4 ft. section, so it is easily transported to the job site in bundles of 9 supports
- The Unipier sleeper support can be conveniently cut to lengths of 6" or longer right on the job site

- TEK screws or other self tapping fasteners are used to attach conduit supports, pipe clamps or other clamp fittings
- **\*Note:** Load not to exceed 50 lbs./6" length  
**Model Number:** RSS4